

## Key information for builders and cablers

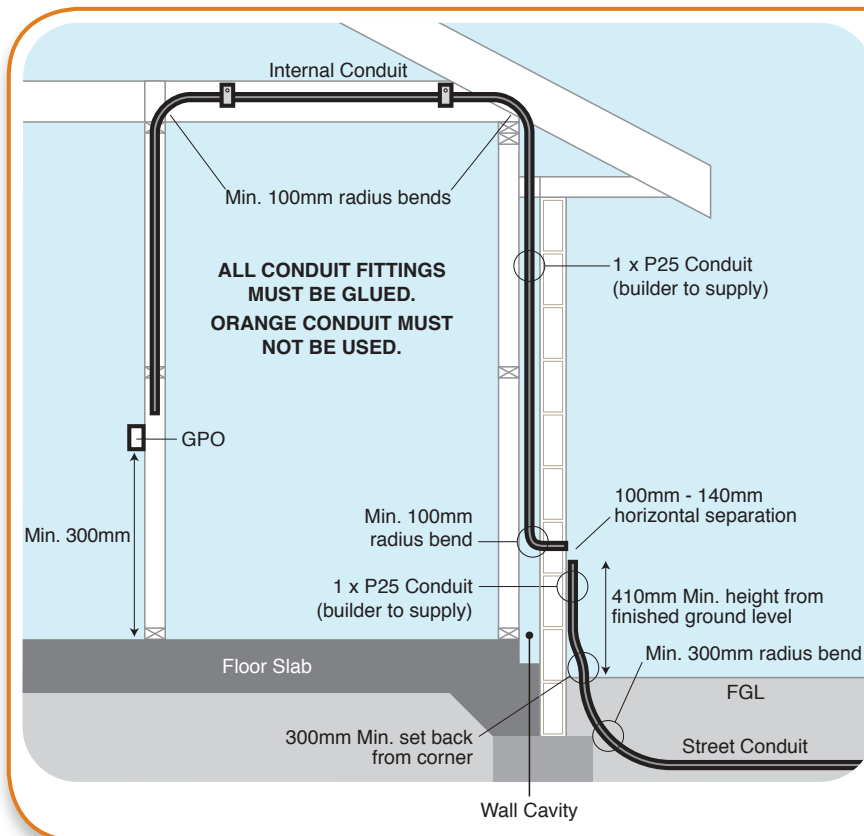

### Supply internal and external conduit paths:

- Use rigid white P25 telecommunications conduits (23mm Internal Diameter) in the trench and within the house. Glue all joints using solvent cement
- Ensure the conduits run as straight as possible
- Install **drawstrings** in both conduits
- Fix all conduits securely to the premises using conduit saddles or similar
- Provide a power point (GPO) within 1500mm of the Network Termination Device (NTD) location
- The bend radius of each street conduit must be no less than 300mm
- The bend radius of each internal conduit must be no less than 100mm
- Use no more than 3 x 90° (max) bends between draw points

#### Separations:

Minimum 250mm from services including:

- Electricity, gas or water meter enclosures
- Water taps or downpipes
- Min. 1.5m side clearance from gas cylinders

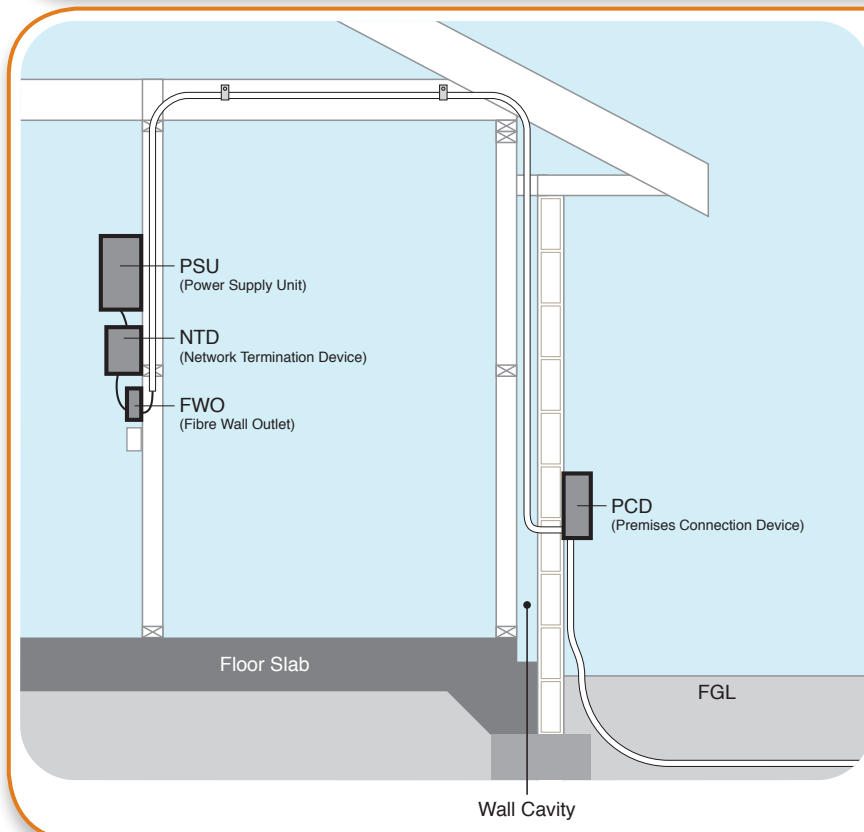

### NBN Co to supply:

- The service drop cable to the Premises Connection Device (PCD) location
- The PCD
- The internal fibre optic cable from PCD to the Fibre Wall Outlet (FWO)
- The NTD
- The Power Supply Unit (PSU)
- All the fibre optic cables

## NBN equipment installed in the home

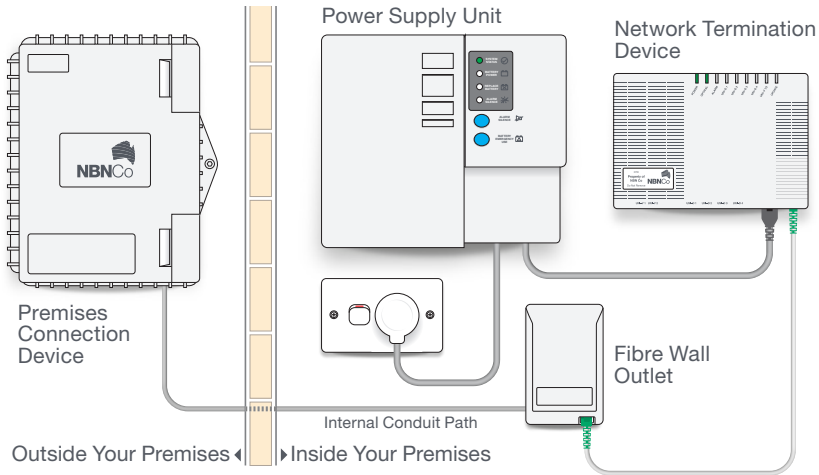

## Preparing new developments for the NBN

It's important that builders and cablers talk to new homeowners about the telecommunications services they may want to access in their homes and provide guidance on where NBN equipment, phone and data outlets should be located for the services they want.

It's important to remember that if customers want to utilise applications like IPTV via Smart TVs in their living room and telework via HD video conferencing in their office they will need fixed cabling in the home to run these services. A wireless modem connected to the NBN will not allow the speeds they need to enjoy the benefits of these types of services.

## Connecting homes to the NBN. Request equipment pre install

To enable a smooth and efficient connection to the National Broadband Network (NBN), builders may request a pre-installation of the in-home equipment supporting NBN access.

Builders need to call 1800 881 816 to request an 'NBN equipment pre install' and make an appointment.

The following will be required:

- Development name
- Premises address/location
- Do the premises have power available?  
If not, what is the expected power connection date?
- Number of premises
- Confirmation that the conduits are in place
- Preferred date for the NBN equipment pre install to occur

Once a request has been made, NBN Co will be in contact to confirm the date and time for the NBN equipment pre installation.



## For more information

Call us on **1800 881 816**

Visit our website at: [www.nbnco.com.au/newdevelopments](http://www.nbnco.com.au/newdevelopments)

Email us at: [newdevelopments@nbnco.com.au](mailto:newdevelopments@nbnco.com.au)

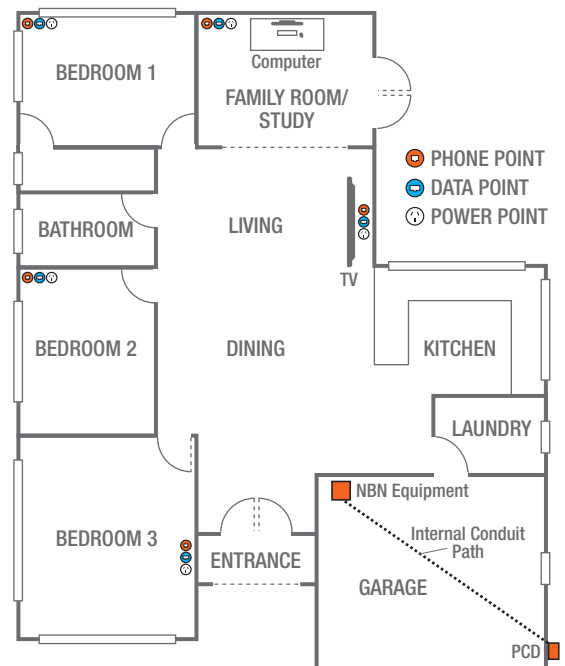

This document is subject to copyright and must not be used except as permitted below or under the Copyright Act 1968 (Cth). You must not reproduce or publish this document in whole or in part for commercial gain without the prior written consent of NBN Co. You may reproduce and publish this document in whole or in part for educational or non-commercial purposes as approved by NBN Co in writing.

This document is intended as an informational guide only. NBN Co does not warrant that the processes and information outlined in this document comply with all (or any) applicable laws, codes of practice or standards. The recipient must exercise its own judgement as to how best to perform the activities described in this document in a safe way, and so as to meet the requirements of all applicable laws, codes of practice and standards. The contents of this document should not be relied upon as representing any NBN Co's final position on the subject matter of this document, except where stated otherwise.

NBN Ready Estate  
**NBNCo** 

[www.nbnco.com.au](http://www.nbnco.com.au)